

**SAM'S LANDING
SATURDAY POND
OTISFIELD, ME.**

DESIGNED BY: RAC

PROPOSED
LARGE ROCK DISPLACED BY
BOAT LAUNCHING IN PREVIOUS YEARS
TO BE MOVED BACK TO SUPPORT
SHORELINE (PREVENT LOSING MATERIAL)

PROPOSED
SEASONAL DOCK 4' X 16' TO
TEMP. TIE KYAK/CANOE
SHORELINE

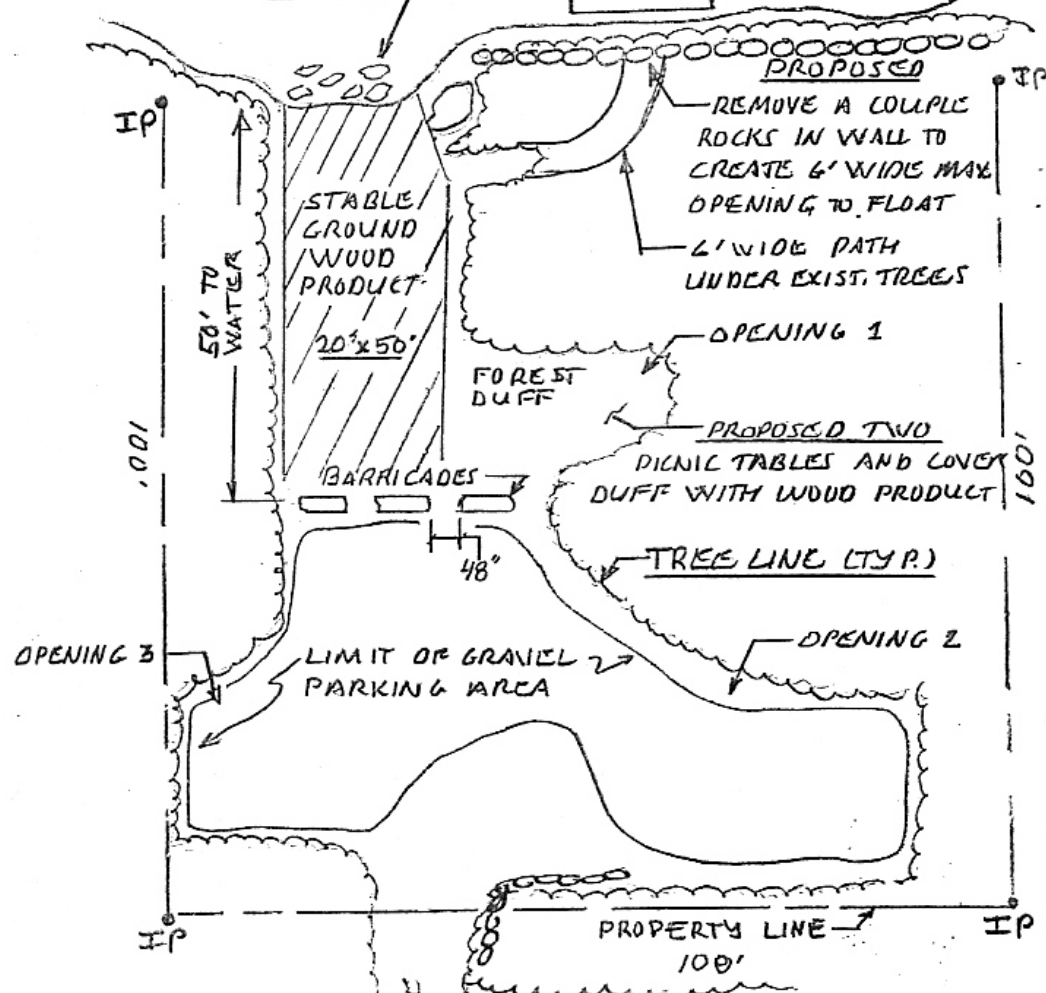

NOTE: SEE PHOTOS FOR
REPLANTING PLAN

SCALE 1" = 20'

NOTE: CARRY IN / OUT ACCESS ONLY